



# ASGA

## Australian Sign & Graphics Awards

# 2010



Category

Details

**Gold Sponsors**

**AVERY GRAPHICS** **Sign Sheet Distributors** **Roland MUTOH** **vi visual impact magazine**

**Silver Sponsors** **EPSON EXCEED YOUR VISION** **3M** **MULFORD PLASTICS delivering solutions** **COREL** **graphic art mart** **ACCORDANCE ARCHITECTURAL** **IMAGE MAGAZINE** **HALFMAK VISION GROUP** **BYE Tapes! The Specialist in Quality Tapes www.ezytapes.com** **GRAVOGRAPH**

**Bronze Sponsors**

**Australian Sign & Graphic Awards**  
T W O T H O U S A N D A N D T E N

**Mounting Sheet**

The key to your 'winning' entry is presentation. Only this blue mounting sheet may be used. Think about submitting 'work in progress' photos, use your skills to present your entry/s in their best representation. (See samples on right.)

**STEP 1 Read the instructions**

Please ensure that you carefully read and pay close attention to the following entry guidelines. By doing this you enable your submission to successfully progress to the judging stage of this competition.

**STEP 2 You will need the following**

- 2.1 **Patience**, Your creative spirit and a little time.
- 2.2 An **Envelope** large enough to enclose 3 additional photos of your entry. These are required for promotional activities, press and audio visuals.
- 2.3 A **Rigid Board** exactly **420 x 297mm (A3)** & **no thicker than 5mm**. (i.e. Cardboard, fluted plastic, foam core.)
- 2.4 **4 X Photos** of the entry. Photos should be glossy or photo quality. (Premium inkjet quality is acceptable). (As a guide 3 @ 130 x 90mm or 2 @ 200 x 125mm photos will fit comfortably).
- 2.5 **Permanent Glue** To flat-mount this Mounting Sheet to the rigid board.
- 2.6 **Masking Tape** To stick the envelope to the back of the rigid board.
- 2.7 **ASGA Entry Form** The official entry form must be used. Forms can be obtained from Sponsors, the ASGA website or ASGA convenor.
- 2.8 **Method of payment** You can choose to send a Cheque, Money Order, Direct Debit (BSB: 032 085, Account 286218 or card (refer enclosed Entry Form for payment options)

**STEP 3 Assembling your entry**

- 3.1 Permanently glue this Mounting Sheet, with this side facing down against the rigid board as described in 2.3 above.
- 3.2 Arrange your photos and glue them permanently in position. Ensure that your arrangement does not exceed the space cut off the blue line by the (See suggested mounts to far right).
- 3.3 Select a 'Category' for your entry. (Refer to the official ASGA Entry Form or the ASGA website.) When filling in the 'Category' & 'Details' boxes on the blue Mounting Sheet you may handwrite contents in black INK only or apply PRINTED text.
- 3.4 In the 'Details' box, include information relevant to the types of materials used to create your entry, how it was constructed and where it is located. **TIP: Often Judges ask for additional information, so don't scimp on the details provided.**
- 3.5 Glue the entry form to the back of your mounted entry. Align the entry form flush against the left edge of the rigid board.
- 3.6 Write **Your Name, Your Company Name, Entry Name, Category Number and Phone Number** on the envelope from 2.2. Insert the additional photos.
- 3.7 Using masking tape affix the envelope to the right of the entry form on the rigid board. (Do not use double sided sticky tape or spray adhesive to affix envelope - refer to 2.2)
- 3.8 Check your entry front to back. Address your package. Send your entry form by fax (1300 274 211) or post to ASGA, PO Box 1313, Crows Nest NSW 1585  
**\*\*Payment is confirmation of entry\*\***  
**(Free Entry is only available to members until 12/4/10)**

FOR MORE HELPFUL HINTS GO TO [www.signs.org.au/signawards.htm](http://www.signs.org.au/signawards.htm)  
(For additional information please contact the ASGA Awards Convenor - Michael Punch (0448 274 211))

1 2 3 VISUAL STEPS

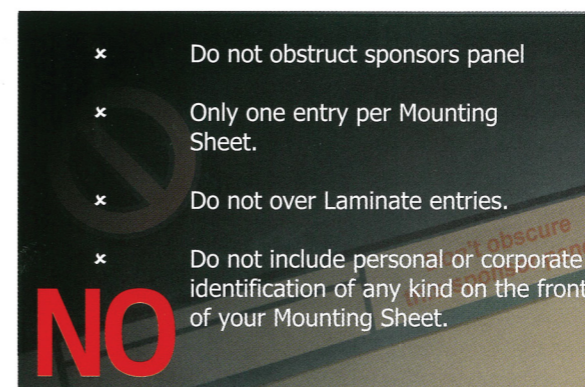
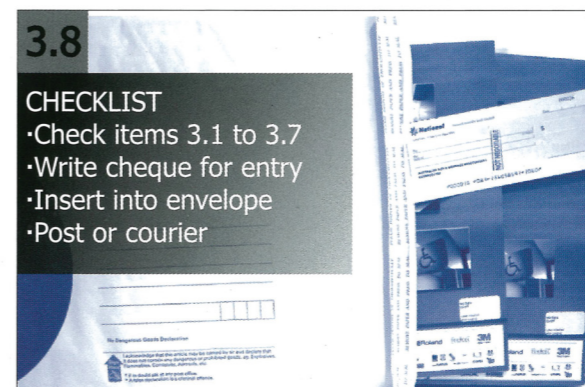
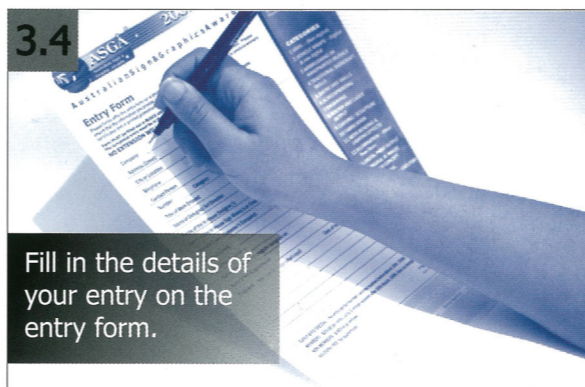
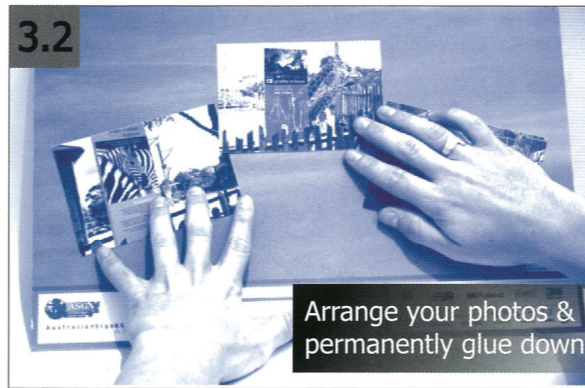

PREVIOUS SAMPLES

